

Pawn Tray

Dustinian Camburides • dustinian@dustinian.com • www.dustinian.com/pawn.tray.html

Summary

This storage tray allows you to find the Pathfinder™ pawns you want just a few minutes before game time. This tray fits inside the Bestiary Box™. You can cut pieces of card stock to serve as dividers/labels.

Note that you'll have to store the Bestiary Box™ flat; no component of this tray holds the pawns “down.”

Supplies

- 3/16” Foamcore (One Sheet)
- Glue/Adhesive (Small Amount)
- Tacks/Brads (50+)
- Hobby/Utility Knife

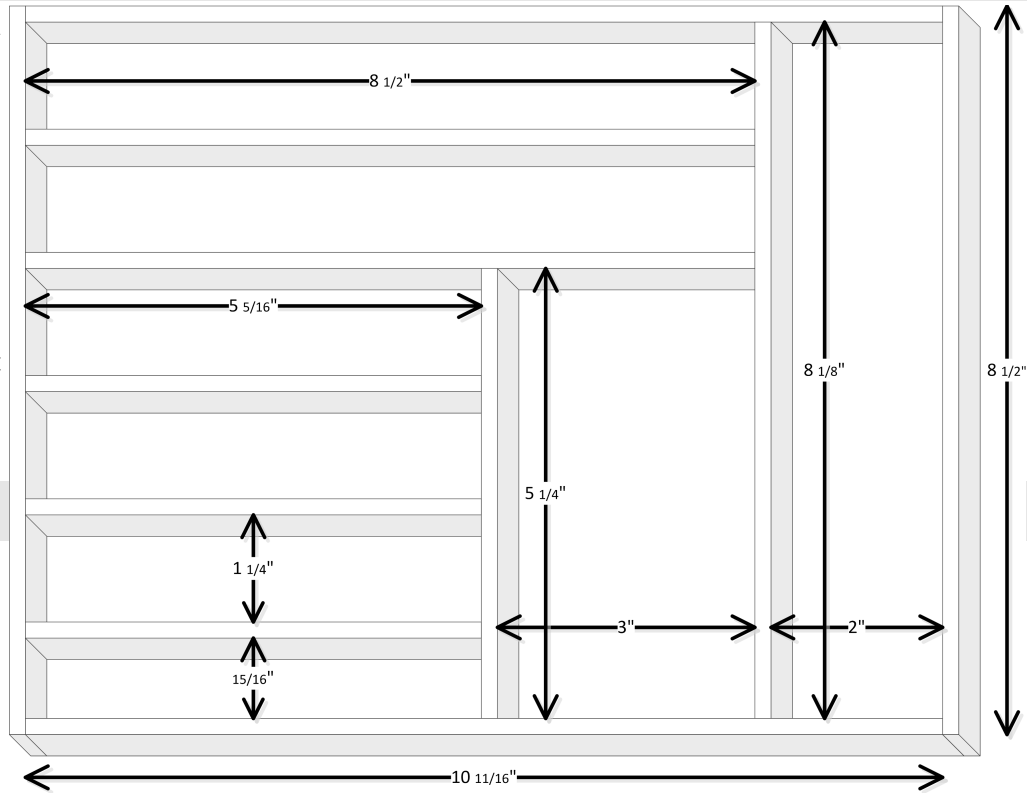

Instructions

1. Cut out the pieces.
2. Glue/tack the long sides to the base.
3. Glue/tack the short sides to the base and long sides.
4. Glue/tack the long divider in place.
5. Glue/tack the medium dividers in place.
6. Glue/tack the short divider in place.
7. Glue/tack the shortest dividers in place.

Pieces to Cut

Qty	Name	Height	Width
1	Base	8 1/8"	10 11/16"
2	Exterior: Long Sides	2"	10 11/16"
2	Exterior: Short Sides	2"	8 1/2"
2	Interior: Long Dividers	1 13/16"	8 1/2"
1	Interior: Medium Divider	1 13/16"	8 1/8"
3	Interior: Short Dividers	1 13/16"	5 5/16"
1	Interior: Shortest Divider	1 13/16"	5 1/4"

Note: "Thickness" omitted from table above since all pieces of foamcore should be 3/16" thick.